

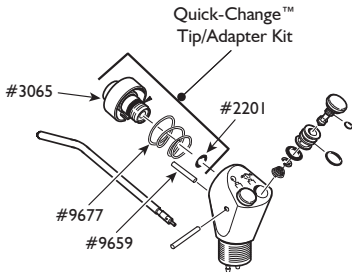

## Replacement Kit, Quick-Change™ Kit Adapter 3089

---



305 N. Springbrook Road, Newberg, OR 97132 USA  
www.dcionline.com

503.538.8343

800.624.2793

91702, Rev. E, 07/15

## **REPLACEMENT INSTRUCTIONS**

### **Removing Old Parts**

1. Remove the following parts from the syringe head:
  - a. DCI Tip Adapter Assembly #3065; using the 5/32 hex wrench provided, insert it in the front of the Quick-Change™ Tip Adapter and turn counterclockwise to remove.
  - b. Tip Adapter Spring #9677.
  - c. Tip Adapter Pin #9659; using needle nose pliers or hemostats, pull straight out to remove.
  - d. Syringe Head O-ring #2201; remove from recessed seat in syringe head.
2. Inspect internal surfaces of syringe head for debris.
3. Clean internal surfaces of syringe head with a cotton swab soaked in alcohol.

### **Installing New Parts**

1. Insert O-ring #2201 in recessed seat in syringe head and lightly lubricate with DCI lubricant #8031.
2. Install Tip Adapter Pin #9659 in hole located in syringe head.
3. Place Tip Adapter Spring #9677 in syringe head making sure it is centered.
4. Locate slot on outside ring of the Quick-Change™ Tip Adapter and insert the adapter in the syringe head, lining up the slot with the Tip Adapter Pin.
5. Using the 5/32 hex wrench, screw in the Tip Adapter Assembly #3065 until firmly in place.
6. Check the operation of the Quick-Change™ Tip Adapter by pushing in the outside ring to make sure it moves freely and holds the syringe tip in place.