

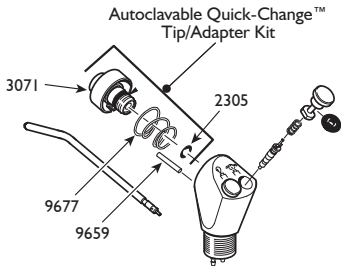

Replacement Kit, Autoclavable Quick-Change™ Kit Adapter 3088



305 N. Springbrook Road, Newberg, OR 97132 USA
www.dcionline.com

503.538.8343

800.624.2793

92287, Rev. C, 07/15

REPLACEMENT INSTRUCTIONS

Removing Old Parts

1. Remove the following parts from the syringe head:
 - a. DCI Tip Adapter Assembly #3071; using the 5/32 hex wrench provided, insert it in the front of the Quick-Change™ Tip Adapter and turn counterclockwise to remove.
 - b. Tip Adapter Spring #9677.
 - c. Tip Adapter Pin #9659; using needle nose pliers or hemostats, pull straight out to remove.
 - d. Syringe Head O-Ring #2305; remove from recessed seat in syringe head.
2. Inspect internal surfaces of syringe head for debris.
3. Clean internal surfaces of syringe head with a cotton swab soaked in alcohol.

Installing New Parts

1. Insert O-Ring #2305 in recessed seat in syringe head and lightly lubricate with DCI lubricant #8031.
2. Install Tip Adapter Pin #9659 in hole located in syringe head.
3. Place Tip Adapter Spring #9677 in syringe head making sure it is centered.
4. Locate slot on outside ring of the Quick-Change™ Tip Adapter and insert the adapter in the syringe head, lining up the slot with the Tip Adapter Pin.
5. Using the 5/32 hex wrench, screw in the Tip Adapter Assembly #3071 until firmly in place.
6. Check the operation of the Quick-Change™ Tip Adapter by pushing in the outside ring to make sure it moves freely and holds the syringe tip in place.