

# PRECISION COMFORT, ONE BUTTON STANDARD SYRINGE



ENGLISH

Applicable to PNs: 3480, 3485, 3487, 3489, 3492, 3493, 3640, 3641, 3642, 3643, 3644, 3645

## Syringe Parts

- |       |                                 |           |
|-------|---------------------------------|-----------|
| #0075 | 10-32 Barb & Washer             | (Pkg. 10) |
| #2202 | O-Ring                          | (Pkg. 12) |
| #2201 | O-Ring                          | (Pkg. 12) |
| #2267 | O-Ring                          | (Pkg. 12) |
| #2293 | O-Ring                          | (Pkg. 12) |
| #3060 | Syringe Tip                     | (1 ea.)   |
| #3180 | Syringe Tip Indexing            | (1 ea.)   |
| #3061 | Syringe Tip                     | (Pkg. 5)  |
| #3181 | Syringe Tip Indexing            | (Pkg. 5)  |
| #3059 | Syringe Tip                     | (Pkg. 50) |
| #3182 | Syringe Tip Indexing            | (Pkg. 50) |
| #3065 | Tip Adapter Assembly            |           |
| #3637 | Button Valve Assembly           |           |
| #3093 | Button Assembly, QC Syringe     |           |
| #3090 | Valve Core                      | (Pkg. 10) |
| #3491 | Handle, Quick-Clean Syringe     |           |
| #9601 | Retaining Ring                  |           |
| #9648 | Pin, Quick-Clean Syringe Button |           |
| #9659 | Pin, Tip Adapter                |           |
| #9674 | Spring, Syringe Button          |           |
| #9676 | Spring, Syringe Button          |           |
| #9677 | Spring, Tip Adapter             |           |

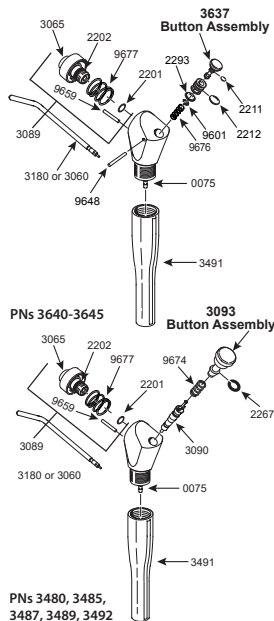

**R** DCI One button syringes are designed for professionals in the dental industry to supply either air or water to the oral cavity during dental procedures for rinsing purposes. It is operated by depressing the to precisely deliver water or dry air for rinsing, cooling or drying the preparation area.

## INSTALLATION

Turn off the air and water supplies. Connect tubing to the air or water outlet on the dental unit or syringe manifold. Maximum operating pressures: Air 80 psi, Water 40 psi. DCI dental units use a manifold block to which the tubing from the syringe gets attached. Supply lines going into the block are: Red tubing water and gray or yellow for air. See fig. I.

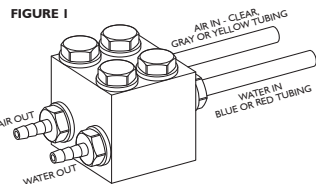

## OPERATION

To operate the one button syringe, simply depress the button and air or water is delivered to the treatment area.

## CHANGING THE TIP

A sterile syringe tip should be installed for each patient. To prevent contamination, sterile tips should be handled with a sterile gauze pad. To remove the syringe tip, press down on the large collar. When you feel a soft "click", the tip may be pulled straight out. Hold the collar down and insert the new tip. Be sure to press it all the way in, and then release the collar.

**CAUTION!** Syringe tip may eject if it is not properly installed. Test the installation by giving a firm pull on the tip to assure that it is inserted all the way, and that the locking mechanism is fully engaged.



**NOTE:** Syringes and tips are shipped non-sterile.

## ASEPSIS

DCI dental syringes are considered a noncritical item. Use disposable barrier protection or a hospital disinfectant to disinfect the syringe between each patient or when the barrier has been compromised. When visibly contaminated with blood or other potentially infectious materials, an EPA-registered hospital disinfectant with a tuberculocidal claim should be used.

Syringe tips are considered semicritical and must be sterilized after each use.

## CLEANING

Clean the external surfaces of the syringe using a solution of mild detergent and warm water. A soft bristled brush may be used to clean around the buttons, tip collar and syringe threads

Do not use powdered cleansers, scouring pads or abrasive scrubbers any of which can damage the surface finish of the syringe.

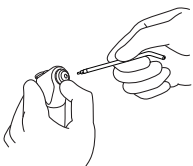

# PRECISION COMFORT, ONE BUTTON STANDARD SYRINGE



ENGLISH

Applicable to PNs: 3480, 3485, 3487, 3489, 3492, 3493, 3640, 3641, 3642, 3643, 3644, 3645

## Syringe Parts

- |       |                                 |           |
|-------|---------------------------------|-----------|
| #0075 | 10-32 Barb & Washer             | (Pkg. 10) |
| #2202 | O-Ring                          | (Pkg. 12) |
| #2201 | O-Ring                          | (Pkg. 12) |
| #2267 | O-Ring                          | (Pkg. 12) |
| #2293 | O-Ring                          | (Pkg. 12) |
| #3060 | Syringe Tip                     | (1 ea.)   |
| #3180 | Syringe Tip Indexing            | (1 ea.)   |
| #3061 | Syringe Tip                     | (Pkg. 5)  |
| #3181 | Syringe Tip Indexing            | (Pkg. 5)  |
| #3059 | Syringe Tip                     | (Pkg. 50) |
| #3182 | Syringe Tip Indexing            | (Pkg. 50) |
| #3065 | Tip Adapter Assembly            |           |
| #3637 | Button Valve Assembly           |           |
| #3093 | Button Assembly, QC Syringe     |           |
| #3090 | Valve Core                      | (Pkg. 10) |
| #3491 | Handle, Quick-Clean Syringe     |           |
| #9601 | Retaining Ring                  |           |
| #9648 | Pin, Quick-Clean Syringe Button |           |
| #9659 | Pin, Tip Adapter                |           |
| #9674 | Spring, Syringe Button          |           |
| #9676 | Spring, Syringe Button          |           |
| #9677 | Spring, Tip Adapter             |           |

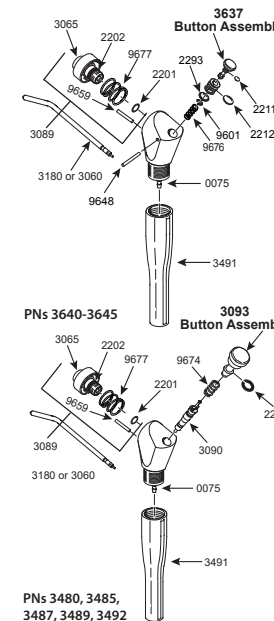

**R** DCI One button syringes are designed for professionals in the dental industry to supply either air or water to the oral cavity during dental procedures for rinsing purposes. It is operated by depressing the to precisely deliver water or dry air for rinsing, cooling or drying the preparation area.

## INSTALLATION

Turn off the air and water supplies. Connect tubing to the air or water outlet on the dental unit or syringe manifold. Maximum operating pressures: Air 80 psi, Water 40 psi. DCI dental units use a manifold block to which the tubing from the syringe gets attached. Supply lines going into the block are: Red tubing water and gray or yellow for air. See fig. I.

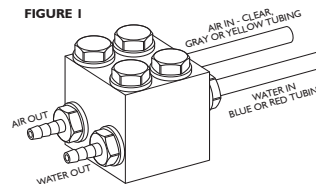

## OPERATION

To operate the one button syringe, simply depress the button and air or water is delivered to the treatment area.

## CHANGING THE TIP

A sterile syringe tip should be installed for each patient. To prevent contamination, sterile tips should be handled with a sterile gauze pad. To remove the syringe tip, press down on the large collar. When you feel a soft "click", the tip may be pulled straight out. Hold the collar down and insert the new tip. Be sure to press it all the way in, and then release the collar.

**CAUTION!** Syringe tip may eject if it is not properly installed. Test the installation by giving a firm pull on the tip to assure that it is inserted all the way, and that the locking mechanism is fully engaged.



**NOTE:** Syringes and tips are shipped non-sterile.

## ASEPSIS

DCI dental syringes are considered a noncritical item. Use disposable barrier protection or a hospital disinfectant to disinfect the syringe between each patient or when the barrier has been compromised. When visibly contaminated with blood or other potentially infectious materials, an EPA-registered hospital disinfectant with a tuberculocidal claim should be used.

Syringe tips are considered semicritical and must be sterilized after each use.

## CLEANING

Clean the external surfaces of the syringe using a solution of mild detergent and warm water. A soft bristled brush may be used to clean around the buttons, tip collar and syringe threads

Do not use powdered cleansers, scouring pads or abrasive scrubbers any of which can damage the surface finish of the syringe.

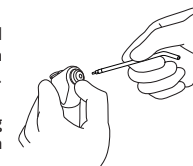

## DISINFECTING

The use of an EPA-registered hospital disinfectant is adequate. Follow disinfectant manufacturer's instructions for use when disinfecting syringe heads.

## TIP STERILIZATION

Clean tips under running water for 30 seconds with a soft brush and place in an ultrasonic bath with an enzymatic cleaner to remove superficial debris prior to sterilization; any debris may reduce the effectiveness of the sterilization. Sterilization process is by steam autoclave. Parameters for wrapped are 132°C (270°F) for 15 minutes at temperature with a 30-minute drying time when using a gravity displacement autoclave. Parameters for unwrapped are 132°C (270°F) for 3 minutes at temperature when using a gravity displacement autoclave.



## MAINTENANCE

Syringe parts that are subject to wear under normal use are provided in a syringe repair kit included with your new syringe. Repair kit includes all necessary tools to repair the syringe.

## REPLACEMENT PARTS

Use only genuine DCI replacement parts which are designed specifically for your syringe to properly function.

## LUBRICANT

Use only silicone-based lubricant, DCI PN 8032, to lubricate syringe button assemblies and all other O-rings in the syringe.



**CAUTION!** The use of other types of lubricants may cause the O-rings deterioration resulting in syringe malfunction or failure.

## TROUBLESHOOTING

Problem	Solution
Leakage around button	- Replace button assembly
Leakage at the syringe tip	- If water leaks, replace water button assembly - If air leaks, replace air button assembly - Replace small O-ring located behind the Quick- Change adapter
Constant water spray when air button is pressed	- Replace tip - Replace small O-ring located behind the Quick-Change adapter
Leakage at syringe handle	- Verify barbed fittings are tightened - Replace nylon washer

## REPLACING THE BUTTONS INSTRUCTIONS



Before removing button, turn off the dental unit to turn off the air and water supply and bleed pressure from the system by running a handpiece or depressing the button on the syringe while pointing the tip into a container to capture residual water from the system.

Depress the button and hold. Use DCI syringe tool (PN 9287), or similar tool, to push the dowel pin retaining the buttons and once exposed on the opposite end pull it out. Slowly release the buttons and pull the button away from the head.

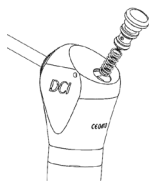

## TIP AND COLLAR ADAPTER INSTRUCTIONS

Remove the syringe tip, and then use the hex key furnished with the Autoclavable Syringe Repair Kit to unscrew the tip adapter. Remove the adapter, collar and spring from the syringe body.

Use a dental pick or a bent paper clip to remove the tiny O-Ring from the bottom of the bore in the syringe body. Be especially careful not to nick or scratch the sealing surfaces. The easiest way to install the replacement is to slip it onto the end of a syringe tip, lubricate the O-Ring, and then insert it into the bore. The O-Ring around the outside of the adapter is thin and fragile, so the new one has to be installed with care.

Before reinstalling the adapter and collar assembly, look down into the bore in the syringe body and assure that the alignment pin is in place. With the spring in place in the collar, align the slot in the collar with the pin, and then push the collar into the syringe body.

Use the hex key to carefully screw in the adapter. Tighten the adapter firmly (35 in-lbs torque). If you don't have a torque measuring device, hold the hex key by the short end and tighten the adapter as tight as you can. This method installs the adapter to approximately 35 in-lbs torque.

## STORAGE

Store in a dry, dust free location and do not mix with contaminated instruments.

Syringe tips shall be kept in a sterilization wrap or pouch to maintain sterility. Refer to the instructions for use from the sterilization packaging manufacturer to determine how long sterility can be maintained.

## DISPOSAL

Contact your local, authorized dealer for disposal of this device to ensure compliance with local environmental regulations.

## PRODUCT SUPPORT

For additional product support, contact DCI Customer Service at 1(800)624-2793 or visit [www.dcionline.com](http://www.dcionline.com)

[www.dcionline.com](http://www.dcionline.com)  
800-624-2793  
PN 92572, Rev. J, 2022-03-18

Applicable Patents:  
U.S. Pat. No. 5,125,835  
5,199,871



DCI International, LLC  
305 N. Springbrook Road  
Newberg, OR 97132 USA

## DISINFECTING

The use of an EPA-registered hospital disinfectant is adequate. Follow disinfectant manufacturer's instructions for use when disinfecting syringe heads.

## TIP STERILIZATION

Clean tips under running water for 30 seconds with a soft brush and place in an ultrasonic bath with an enzymatic cleaner to remove superficial debris prior to sterilization; any debris may reduce the effectiveness of the sterilization. Sterilization process is by steam autoclave. Parameters for wrapped are 132°C (270°F) for 15 minutes at temperature with a 30-minute drying time when using a gravity displacement autoclave. Parameters for unwrapped are 132°C (270°F) for 3 minutes at temperature when using a gravity displacement autoclave.



## MAINTENANCE

Syringe parts that are subject to wear under normal use are provided in a syringe repair kit included with your new syringe. Repair kit includes all necessary tools to repair the syringe.

## REPLACEMENT PARTS

Use only genuine DCI replacement parts which are designed specifically for your syringe to properly function.

## LUBRICANT

Use only silicone-based lubricant, DCI PN 8032, to lubricate syringe button assemblies and all other O-rings in the syringe.



**CAUTION!** The use of other types of lubricants may cause the O-rings deterioration resulting in syringe malfunction or failure.

## TROUBLESHOOTING

Problem	Solution
Leakage around button	- Replace button assembly
Leakage at the syringe tip	- If water leaks, replace water button assembly - If air leaks, replace air button assembly - Replace small O-ring located behind the Quick- Change adapter
Constant water spray when air button is pressed	- Replace tip - Replace small O-ring located behind the Quick-Change adapter
Leakage at syringe handle	- Verify barbed fittings are tightened - Replace nylon washer

## REPLACING THE BUTTONS INSTRUCTIONS



Before removing button, turn off the dental unit to turn off the air and water supply and bleed pressure from the system by running a handpiece or depressing the button on the syringe while pointing the tip into a container to capture residual water from the system.

Depress the button and hold. Use DCI syringe tool (PN 9287), or similar tool, to push the dowel pin retaining the buttons and once exposed on the opposite end pull it out. Slowly release the buttons and pull the button away from the head.

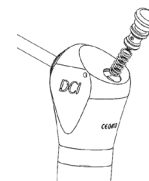

## TIP AND COLLAR ADAPTER INSTRUCTIONS

Remove the syringe tip, and then use the hex key furnished with the Autoclavable Syringe Repair Kit to unscrew the tip adapter. Remove the adapter, collar and spring from the syringe body.

Use a dental pick or a bent paper clip to remove the tiny O-Ring from the bottom of the bore in the syringe body. Be especially careful not to nick or scratch the sealing surfaces. The easiest way to install the replacement is to slip it onto the end of a syringe tip, lubricate the O-Ring, and then insert it into the bore. The O-Ring around the outside of the adapter is thin and fragile, so the new one has to be installed with care.

Before reinstalling the adapter and collar assembly, look down into the bore in the syringe body and assure that the alignment pin is in place. With the spring in place in the collar, align the slot in the collar with the pin, and then push the collar into the syringe body.

Use the hex key to carefully screw in the adapter. Tighten the adapter firmly (35 in-lbs torque). If you don't have a torque measuring device, hold the hex key by the short end and tighten the adapter as tight as you can. This method installs the adapter to approximately 35 in-lbs torque.

## STORAGE

Store in a dry, dust free location and do not mix with contaminated instruments.

Syringe tips shall be kept in a sterilization wrap or pouch to maintain sterility. Refer to the instructions for use from the sterilization packaging manufacturer to determine how long sterility can be maintained.

## DISPOSAL

Contact your local, authorized dealer for disposal of this device to ensure compliance with local environmental regulations.

## PRODUCT SUPPORT

For additional product support, contact DCI Customer Service at 1(800)624-2793 or visit [www.dcionline.com](http://www.dcionline.com)

[www.dcionline.com](http://www.dcionline.com)  
800-624-2793  
PN 92572, Rev. J, 2022-03-18

Applicable Patents:  
U.S. Pat. No. 5,125,835  
5,199,871



DCI International, LLC  
305 N. Springbrook Road  
Newberg, OR 97132 USA